

Multi purpose waist banding machine

DLR1509SPF

6 needle flat-bed double chain stitch machine for heavy duty waist banding with angle-adjustable mechanism, double feed dog system "ORIGINAL JAPAN MADE SPECIAL NEEDLE GAUGE" and CURVED WAIST BANDING MECHANISM



major gauge 5 size in one machine !!

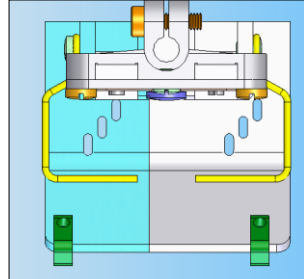
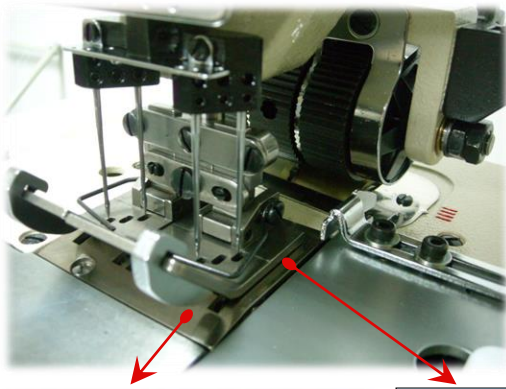

6 loopers pre-installed Split type presser foot

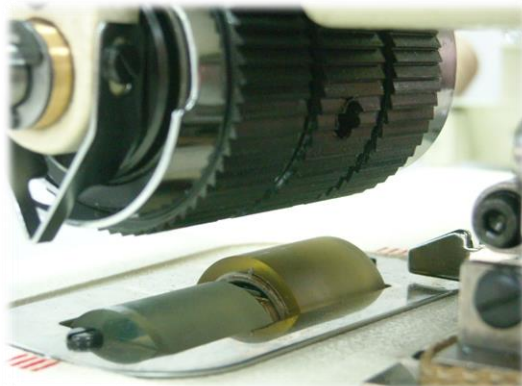
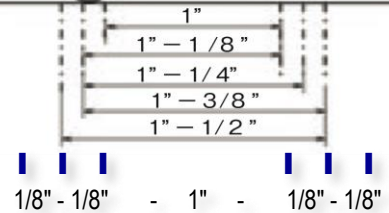
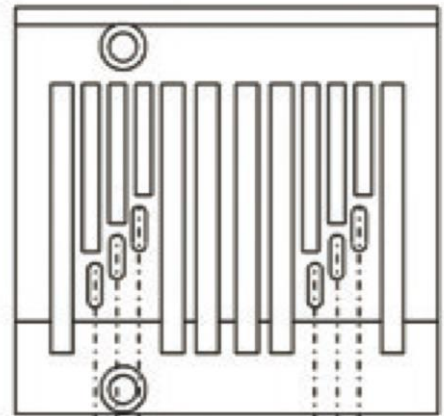

Gear iron upper puller and split type rubber lower puller

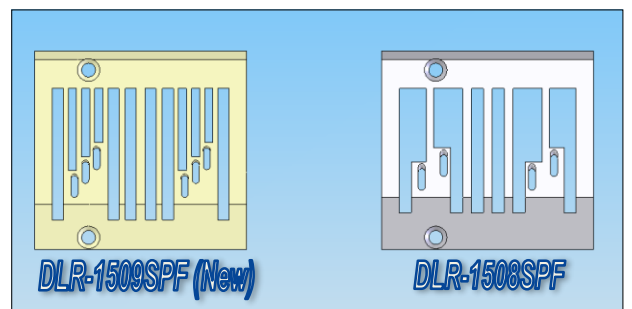

DLR1509SPF

*Bracket for curved folder
In the accessory box*

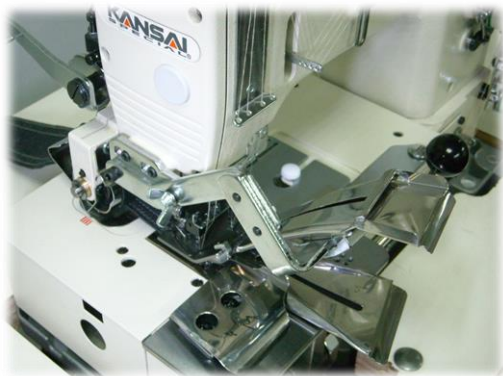

Easy 3 steps adjustment

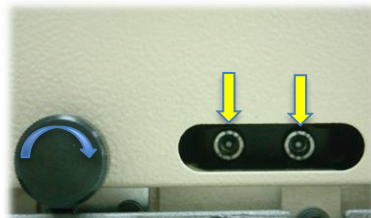

① Loose 2 screw



② Loose 2 screw and make angle by knob

Double feed dog for smooth curve

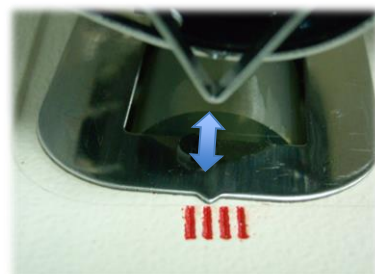
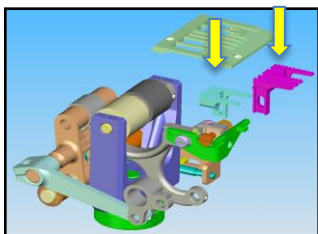

③ Align upper puller and lower puller and tighten screws

- ① Left-Right looper movement give you very tight and stable stitches for heavy duty material.
- ② Kansai original 1/8"-1/8"-1"-1/8"-1/8" gauge provides various gauge combinations.
- ③ 6 loopers already built in the machine. No extra cost required for changing gauge size.
- ④ Split type presser foot and metal rear puller makes consistent stitches for waist banding.
- ⑤ Kansai original angle-adjustable puller mechanism and double feed dog mechanism makes beautiful curved waist band.

Model Name	Application	Material	Needle	No. of threads	Needle gauge	Needle bar stroke	Stitch length	Diff.Feed ratio	Presser foot lift	Maximum Speed
DLR1509SPF	Waist banding	Extra heavy	TV-5 #21 x 4needles	8	1/8"-1/8"-1"-1/8"-1/8"	34	7~16 stitch/inch	N/A	10mm	4500
DLR1508SPF	Waist banding	Extra heavy	TV-5 #21 x 4needles	8	1/4"-1"-1/4" 1/4"-7/8"-1/4"	34	7~16 stitch/inch	N/A	10mm	4500

